

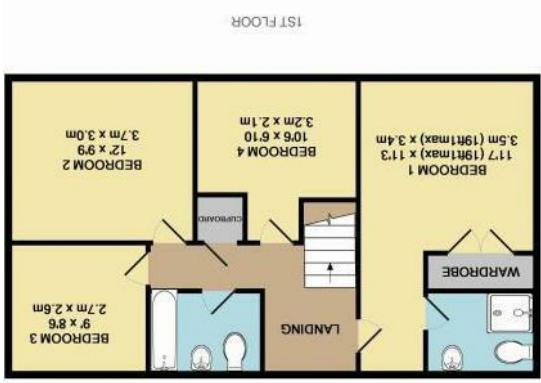

Norfolk Property online.

The Pines | Norwich | NR4
Guide price £400,000

Energy Efficiency Rating	
Potential	Current
England & Wales EU Directive 2002/91/EC	
<i>Very energy efficient - lower running costs</i>	
A (92 plus)	
B (81-91)	
C (69-80)	
D (55-68)	
E (39-54)	
F (21-38)	
G (1-20)	
<i>Not energy efficient - higher running costs</i>	



Whilst every attempt has been made to ensure the accuracy of the floor plan contained here, measurements of doors, windows, rooms and any other items are approximate and no responsibility is taken for any error. This plan is for illustrative purposes only and should be used as such by any prospective purchaser. The services, systems and appliances shown have not been tested and no guarantee as to their capability or efficiency can be given. Made with MetreX (2013)

Disclaimer - In accordance with the Property Misdescriptions Act, the company gives notice that all descriptions, references to condition, necessary permissions for use and other details are given in good faith and believed to be correct, but any intending lessees do not rely on them as statements of fact, but must satisfy themselves by inspection or other means, as to their accuracy.

**Norfolk Property
online.**

Norfolk Property Online presents an immaculately presented detached house located down a private driveway within the popular Roundhouse Development in Cringleford. The property an entrance hall, dual aspect sitting room, modern kitchen breakfast room, large conservatory, utility room and downstairs w/c. On the first floor, there are four generous bedrooms with master en suite shower room and three piece family bathroom. To the front the property benefits from off road parking and a detached double garage with an enclosed garden to the rear.

